

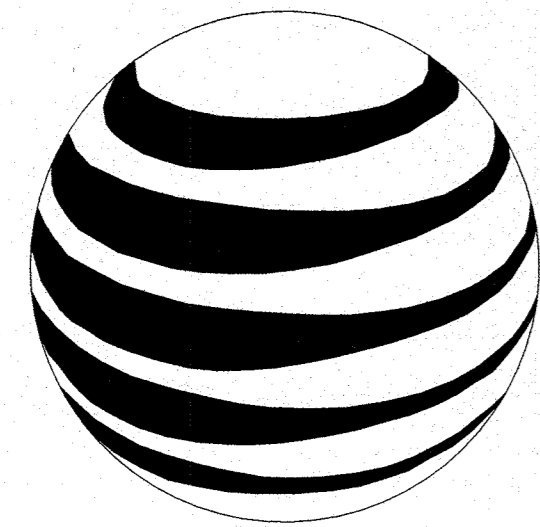

**Milestone
Towers**



at&t

MILESTONE TOWERS GRACE COMMUNITY CHURCH SITE 8200 OLD COLUMBIA ROAD FULTON, MD 20759 ZONING DRAWINGS

entrex
communication services, inc.
6100 Executive Blvd., Suite 430
Rockville, MD 20852
Phone: (202)408-0960

SUBMITTALS		
DATE	DESCRIPTION	REV.
11-30-22	ZONING REVIEW	
01-09-23	MILESTONE COMMENTS	
01-31-23	MILESTONE COMMENTS	
03-03-23	COUNTY COMMENTS	

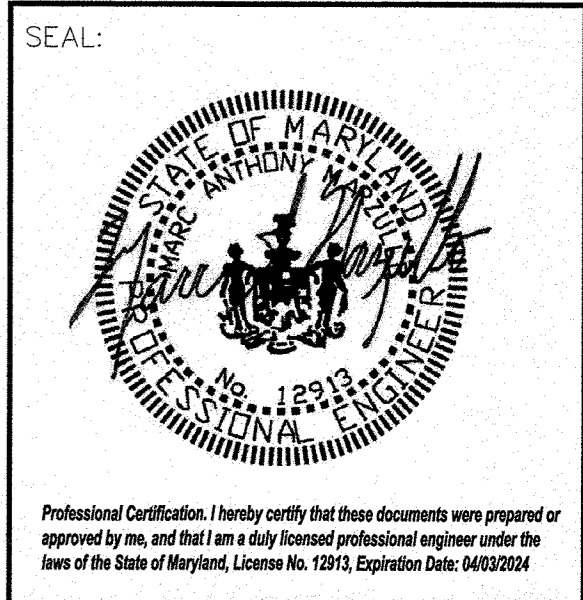

NOTE: MONOPOLES AND COMMUNICATION TOWERS SHALL BE INSTALLED IN CONFORMANCE WITH ANS/EIA/TIA-222H, STRUCTURAL STANDARDS FOR STEEL ANTENNA TOWERS AND ANTENNA SUPPORTING STRUCTURES.

GENERAL NOTES

- THE CONTRACTOR SHALL GIVE ALL NOTICES AND COMPLY WITH ALL LAWS, ORDINANCES, RULES, REGULATIONS AND LAWFUL ORDERS OF ANY PUBLIC AUTHORITY, MUNICIPAL AND UTILITY COMPANY SPECIFICATIONS, AND LOCAL AND STATE JURISDICTIONAL CODES BEARING ON THE PERFORMANCE OF THE WORK. THE WORK PERFORMED ON THE PROJECT AND THE MATERIALS INSTALLED SHALL BE IN STRICT ACCORDANCE WITH ALL APPLICABLE CODES, REGULATIONS AND ORDINANCES.
- THE ARCHITECT/ENGINEER HAS MADE EVERY EFFORT TO SET FORTH IN THE CONSTRUCTION AND CONTRACT DOCUMENTS THE COMPLETE SCOPE OF WORK. THE CONTRACTOR BIDDING THE JOB IS NEVERTHELESS CAUTIONED THAT MINOR OMISSIONS OR ERRORS IN THE DRAWINGS AND OR SPECIFICATIONS SHALL NOT EXCUSE SAID CONTRACTOR FROM COMPLETING THE PROJECT AND IMPROVEMENTS IN ACCORDANCE WITH THE INTENT OF THESE DOCUMENTS.
- THE CONTRACTOR OR BIDDER SHALL BEAR THE RESPONSIBILITY OF NOTIFYING (IN WRITING) THE PROJECT MANAGER OF ANY CONFLICTS, ERRORS, OR OMISSIONS PRIOR TO THE SUBMISSION OF CONTRACTOR'S PROPOSAL OR PERFORMANCE OF WORK. IN THE EVENT OF DISCREPANCIES THE CONTRACTOR SHALL PRICE THE MORE COSTLY OR EXTENSIVE WORK, UNLESS DIRECTED IN WRITING OTHERWISE.
- THE SCOPE OF WORK SHALL INCLUDE FURNISHING ALL MATERIALS, EQUIPMENT, LABOR AND ALL OTHER MATERIALS AND LABOR DEEMED NECESSARY TO COMPLETE THE WORK/PROJECT AS DESCRIBED HEREIN.
- THE CONTRACTOR SHALL VISIT THE JOB SITE PRIOR TO THE SUBMISSION OF BIDS OR PERFORMING WORK TO FAMILIARIZE HIMSELF WITH THE FIELD CONDITIONS AND TO VERIFY THAT THE PROJECT CAN BE CONSTRUCTED IN ACCORDANCE WITH THE CONTRACT DOCUMENTS.
- THE CONTRACTOR SHALL OBTAIN AUTHORIZATION TO PROCEED WITH CONSTRUCTION PRIOR TO STARTING WORK ON ANY ITEM NOT CLEARLY DEFINED BY THE CONSTRUCTION DRAWING/CONTRACT DOCUMENTS.
- THE CONTRACTOR SHALL INSTALL ALL EQUIPMENT AND MATERIALS ACCORDING TO THE MANUFACTURER'S/VENDOR'S SPECIFICATION UNLESS NOTED OTHERWISE OR WHERE LOCAL CODES OR ORDINANCES TAKE PRECEDENCE.
- THE CONTRACTOR SHALL PROVIDE A FULL SET OF CONSTRUCTION DOCUMENTS AT THE SITE UPDATED WITH THE LATEST REVISIONS AND ADDENDA OR CLARIFICATIONS AVAILABLE FOR THE USE BY ALL PERSONNEL INVOLVED WITH THE PROJECT.
- THE CONTRACTOR SHALL SUPERVISE AND DIRECT THE PROJECT DESCRIBED HEREIN. THE CONTRACTOR SHALL BE SOLELY RESPONSIBLE FOR ALL CONSTRUCTION MEANS, METHODS, TECHNIQUES, SEQUENCES AND PROCEDURES AND FOR COORDINATING ALL PORTIONS OF THE WORK UNDER THE CONTRACT.
- THE CONTRACTOR SHALL BE RESPONSIBLE FOR OBTAINING ALL TRADE PERMITS AND INSPECTIONS WHICH MAY BE REQUIRED BY THE OWNER ARCHITECT/ENGINEER, THE STATE, COUNTY OR LOCAL GOVERNMENT AUTHORITY.
- THE CONTRACTOR SHALL MAKE NECESSARY PROVISIONS TO PROTECT EXISTING IMPROVEMENTS, EASEMENTS, PAVING, CURBING, ETC. DURING CONSTRUCTION. UPON COMPLETION OF WORK, THE CONTRACTOR SHALL REPAIR ANY DAMAGE THAT MAY HAVE OCCURRED DUE TO CONSTRUCTION ON OR ABOUT THE PROPERTY.
- THE CONTRACTOR SHALL KEEP THE GENERAL WORK AREA CLEAN AND HAZARD FREE DURING CONSTRUCTION AND DISPOSE OF ALL DIRT, DEBRIS, RUBBISH AND REMOVE EQUIPMENT NOT SPECIFIED AS REMAINING ON THE PROPERTY. PREMISES SHALL BE LEFT IN CLEAN CONDITION AND FREE FROM PAINT SPOTS, DUST, OR SMUDGES OF ANY NATURE.
- THE CONTRACTOR SHALL COMPLY WITH ALL OSHA REQUIREMENTS AS THEY APPLY TO THIS PROJECT.
- THE CONTRACTOR SHALL NOTIFY THE PROJECT MANAGER WHERE A CONFLICT OCCURS ON ANY OF THE CONTRACT DOCUMENTS. THE CONTRACTOR IS NOT TO ORDER MATERIAL OR CONSTRUCT ANY PORTION OF THE WORK THAT IS IN CONFLICT UNTIL THE CONFLICT IS RESOLVED BY THE PROJECT MANAGER.
- THE CONTRACTOR SHALL VERIFY ALL DIMENSIONS, ELEVATIONS, PROPERTY LINES, ETC. ON THE PROJECT.

BUILDING CODE

2021 INTERNATIONAL BUILDING CODE

REFERENCING:
2020 NFPA 70 NATIONAL ELECTRICAL
2021 INTERNATIONAL MECHANICAL CODE
2021 NFPA 101 LIFE SAFETY CODE
AMERICAN INSTITUTE OF STEEL CONSTRUCTION
TIA-222-H (2016) STRUCTURAL STANDARDS FOR ANTENNA SUPPORTING STRUCTURES AND ANTENNAS

VICINITY MAP

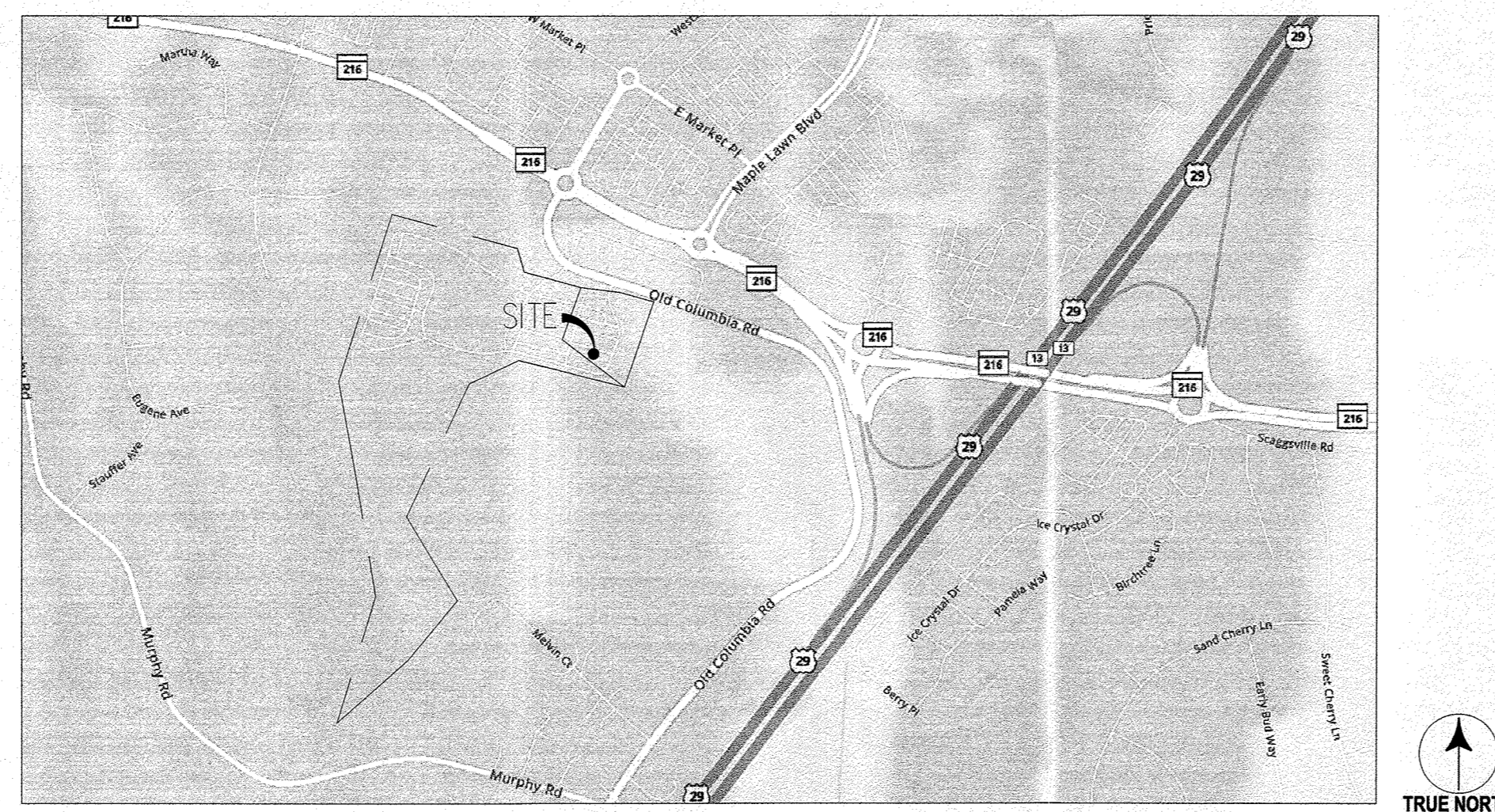

SHEET INDEX

- T-1 TITLE SHEET
- Z-1 SITE PLAN
- Z-1A ADJOINERS LIST
- Z-1B EXISTING CONDITIONS PLAN
- Z-1C CONDITIONAL USE PLAN
- Z-2 PARTIAL SITE PLAN
- Z-3 EROSION AND SEDIMENT CONTROL PLAN AND DETAILS
- Z-4 COMPOUND PLAN
- Z-5 MONOPOLE ELEVATION
- Z-6 SITE DETAILS
- Z-7 AT&T ANTENNA LAYOUT PLAN, SCHEDULE AND DETAILS
- Z-8 AT&T ANTENNA EQUIPMENT DETAILS
- Z-9 AT&T GENERATOR DETAILS
- Z-10 LANDSCAPE PLAN AND DETAILS

SYMBOLS AND ABBREVIATIONS

ADJ	ADJUSTABLE	MECH	MECHANICAL	⬇	SPOT ELEVATION
APPROX	APPROXIMATE	MFR	MANUFACTURER	⊕	CENTERLINE
CAB	CABINET	MGB	MAIN GROUND BAR	⊖	PLATE
CLG	CEILING	MIN	MINIMUM	⊙	DETAIL NUMBER
CONC	CONCRETE	MTL	METAL	⊙	SHEET NUMBER
CONT	CONTINUOUS	NIC	NOT IN CONTRACT	—G—	GROUND WIRE
CJ	CONSTRUCTION JOINT	NTS	NOT TO SCALE	⊠	ANTENNA
DIA	DIAMETER	OC	ON CENTER		
DWG	DRAWING	OPP	OPPOSITE		
EQB	EQUIPMENT GROUND BAR	SF	SQUARE FOOT		
EA	EACH	SHT	SHEET		
ELEC	ELECTRICAL	SIM	SIMILAR		
EL	ELEVATION	SS	STAINLESS STEEL		
EQ	EQUAL	STL	STEEL		
EQUIP	EQUIPMENT	TOC	TOP OF CONCRETE		
EXT	EXTERIOR	TOM	TOP OF MASONRY		
FF	FINISHED FLOOR	TOS	TOP OF STEEL		
GA	GAGE	TYP	TYPICAL		
GALV	GALVANIZED	VIF	VERIFY IN FIELD		
GB	GROUND BAR	UON	UNLESS OTHERWISE NOTED		
GC	GENERAL CONTRACTOR	WWF	WELDED WIRE FABRIC		
GRND	GROUND	W/	WITH		
LG	LONG	&	AND		
LLH	LONG LEG HORIZONTAL	@	AT		
MAX	MAXIMUM				



PROJECT DESCRIPTION

SCOPE OF WORK:

- INSTALL EROSION AND SEDIMENT CONTROLS.
- INSTALL TEMPORARY CONSTRUCTION ENTRANCE.
- CLEAR AND GRADE SITE TO FINAL SUBGRADE ELEVATION.
- INSTALL MONOPOLE FOUNDATION AND 125' MONOPOLE.
- INSTALL GROUNDING, TELCO PULL BOXES, UTILITY WIREWAY.
- INSTALL AT&T GROUND EQUIPMENT, AND PLATFORM AND ANTENNAS ON MONOPOLE.
- INSTALL ELECTRICAL AND TELEPHONE CONDUIT AND HAND HOLES.
- INSTALL FENCE AND SITE IMPROVEMENTS.

PROPERTY OWNER: GRACE COMMUNITY CHURCH OF HOWARD COUNTY
8200 & 8210 OLD COLUMBIA ROAD
FULTON, MD 20759
240-533-1090

APPLICANT: MILESTONE TOWER LIMITED PARTNERSHIP IV
D/B/A MILESTONE COMMUNICATIONS
PO BOX 3210
RESTON, VA 20195
MR. LEN FORKAS
703-620-2555 EXT. 104

COUNSEL FOR APPLICANT: MILLER, MILLER & CANBY
SEAN HUGHES, ESQ.
301-762-5212

JURISDICTION: HOWARD COUNTY
PARCEL ID: 05-387302 LOT 1
PARCEL ID: 05-367867 LOT 2
COUNCIL DISTRICT: 4
ELECTION DISTRICT: 13
ZONING: RR-DEO
LATITUDE: N 39° 08' 43.671"
LONGITUDE: W 76° 54' 32.818"
GROUND ELEVATION: 454.42' AT MONOPOLE BASE

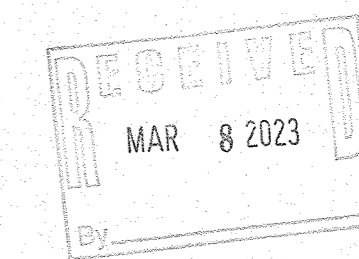

REVISED



PROJECT NO: 1050.364
DESIGNER: M.A.
ENGINEER: M.M.

SCALE:
SCALE AS NOTED ON DRAWING

**GRACE COMMUNITY
CHURCH SITE
8200 OLD COLUMBIA RD.
FULTON, MD 20759**

TITLE:
TITLE SHEET

SHEET NUMBER:
T-1