

VICINITY MAP
SCALE: 1"=2000'
ADC MAP COORDINATES: PAGE 30, GRID 4F

GENERAL NOTES:

1. PROPERTY OUTLINE IS BASED ON DEED PLAT AND FIELD LOCATIONS.
2. TOPOGRAPHY IS BASED ON FIELD SURVEY RUN BY VOGEL ENGINEERING + TIMMONS GROUP AND HOWARD COUNTY GIS.
3. PROPERTY AREA : 11.01 AC.±
4. PROPERTY ZONED: RR-DEO
5. SUBJECT PROPERTY LOCATED IN 5TH ELECTION DISTRICT.
6. TAX MAP: 34 GRID: 21 PARCEL: 287
7. PROJECT IS LOCATED IN HIGHLAND COMMUNITY.
8. SUBJECT TO ENVIRONMENTAL CONCEPT PLAN AND SITE DEVELOPMENT PLAN
9. SUBJECT TO ALL LOCAL, STATE AND FEDERAL REQUIREMENTS AND PERMITS.

LEGEND:

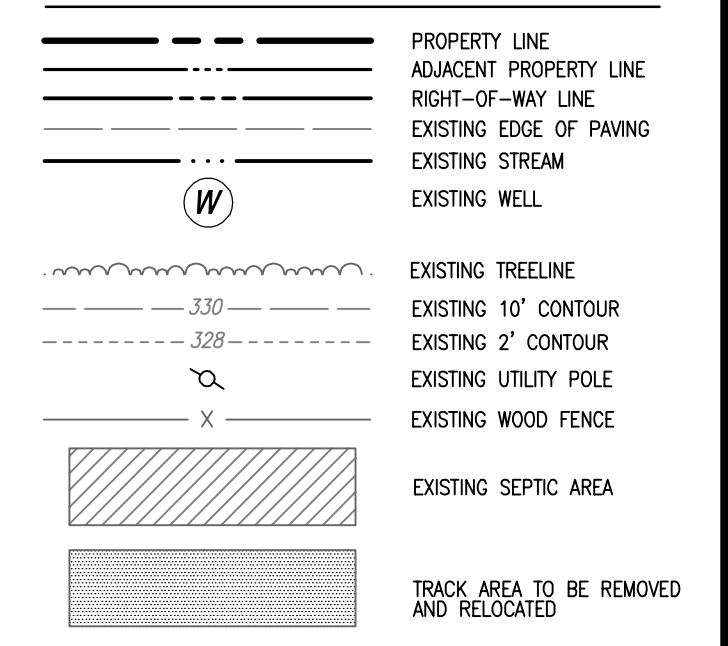

CONDITIONAL USE REQUESTED:

SECTION 131.0.N.6 ATHLETIC FACILITIES, OUTDOOR.

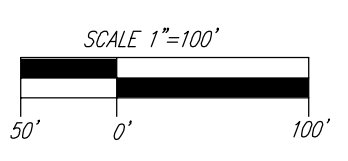

ATTORNEY
TALKIN AND OH, LLP
SANG OH; ESQUIRE
5100 DORSEY HALL DRIVE
ELLCOTT CITY, MD 21042
410-964-0300

OWNER/ PETITIONER
SARAH M. TROXEL
CHARLES C. SIPERKO
6717 MINK HOLLOW RD
HIGHLAND, MD 20777
301-596-5600

NO.	REVISION	DATE

CONDITIONAL USE PLAN
MINK HOLLOW PROPERTY
6717 MINK HOLLOW ROAD, HIGHLAND, MD 20777
L. 16665 F. 00065

TAX MAP: 34 PARCEL: 287 BLOCK: 21 ZONING: RR-DEO
5TH ELECTION DISTRICT HOWARD COUNTY, MARYLAND

VOGEL ENGINEERING

TIMMONS GROUP

3300 NORTH RIDGE ROAD, SUITE 110, ELLICOTT CITY, MD 21043
P: 410.461.7666 F: 410.461.8961 www.timmons.com



DESIGN BY: RHV
DRAWN BY: KG
CHECKED BY: RHV
DATE: JANUARY 2025
SCALE: 1" = 100'
W.O. NO.: 63423

PROFESSIONAL CERTIFICATE
I HEREBY CERTIFY THAT THESE DOCUMENTS WERE PREPARED OR APPROVED BY ME, AND THAT I AM A DULY LICENSED PROFESSIONAL ENGINEER UNDER THE LAWS OF THE STATE OF MARYLAND, LICENSE NO. 16193, EXPIRATION DATE: 09-27-2026